

02 ROOF EDGE / METAL PANEL
SCALE: 3" = 1'-0"

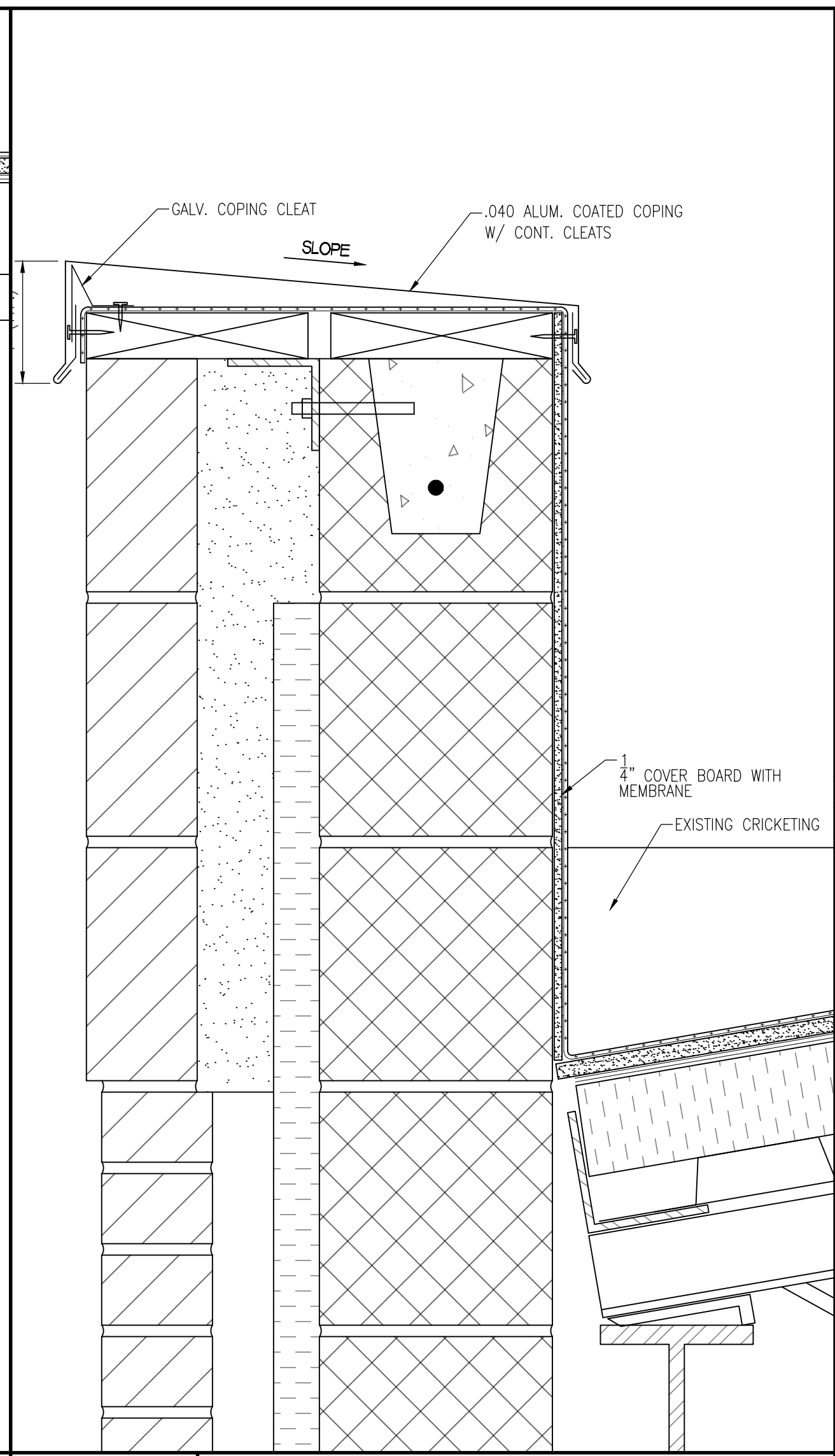

03 ROOF EDGE / CRICKET
SCALE: 3" = 1'-0"

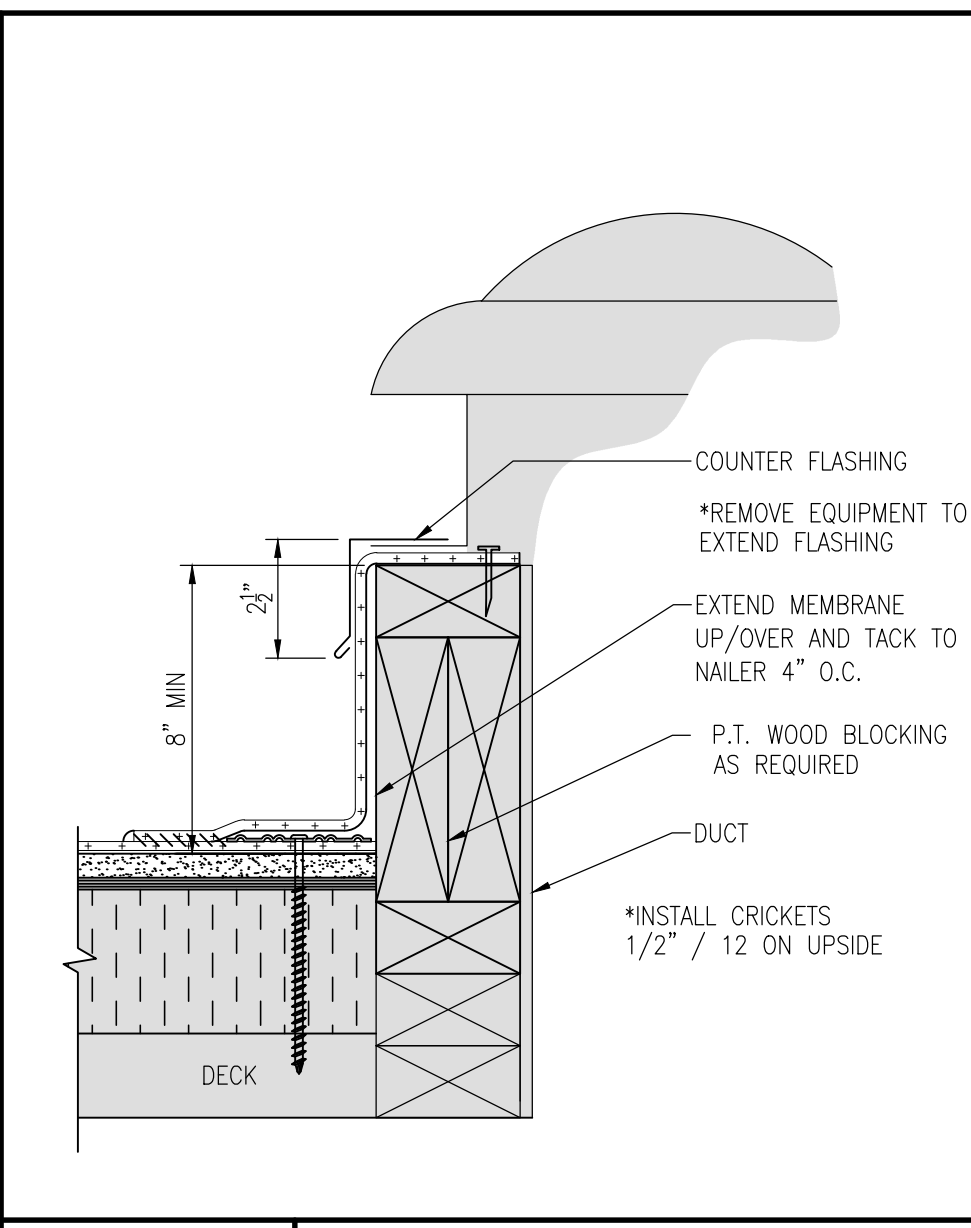

04 COMPOSITION DETAIL
SCALE: 3" = 1'-0"

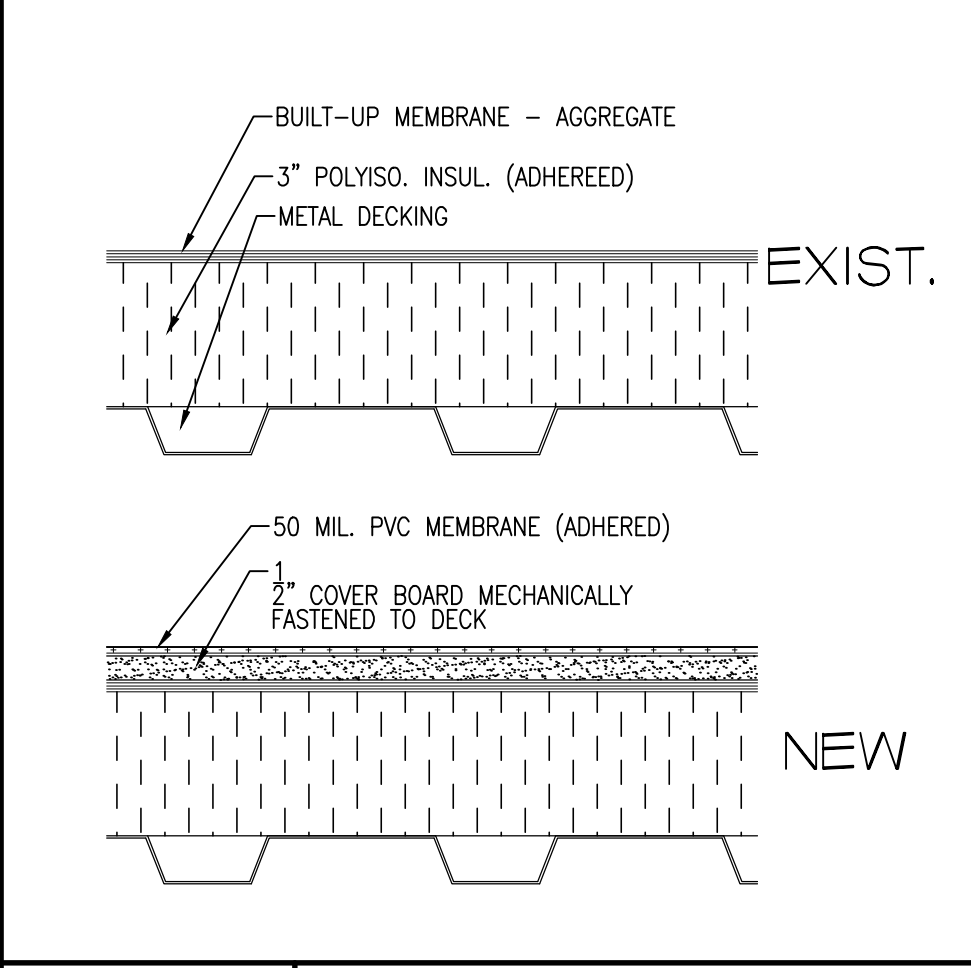

05 VENT / EXH
SCALE: 3" = 1'-0"

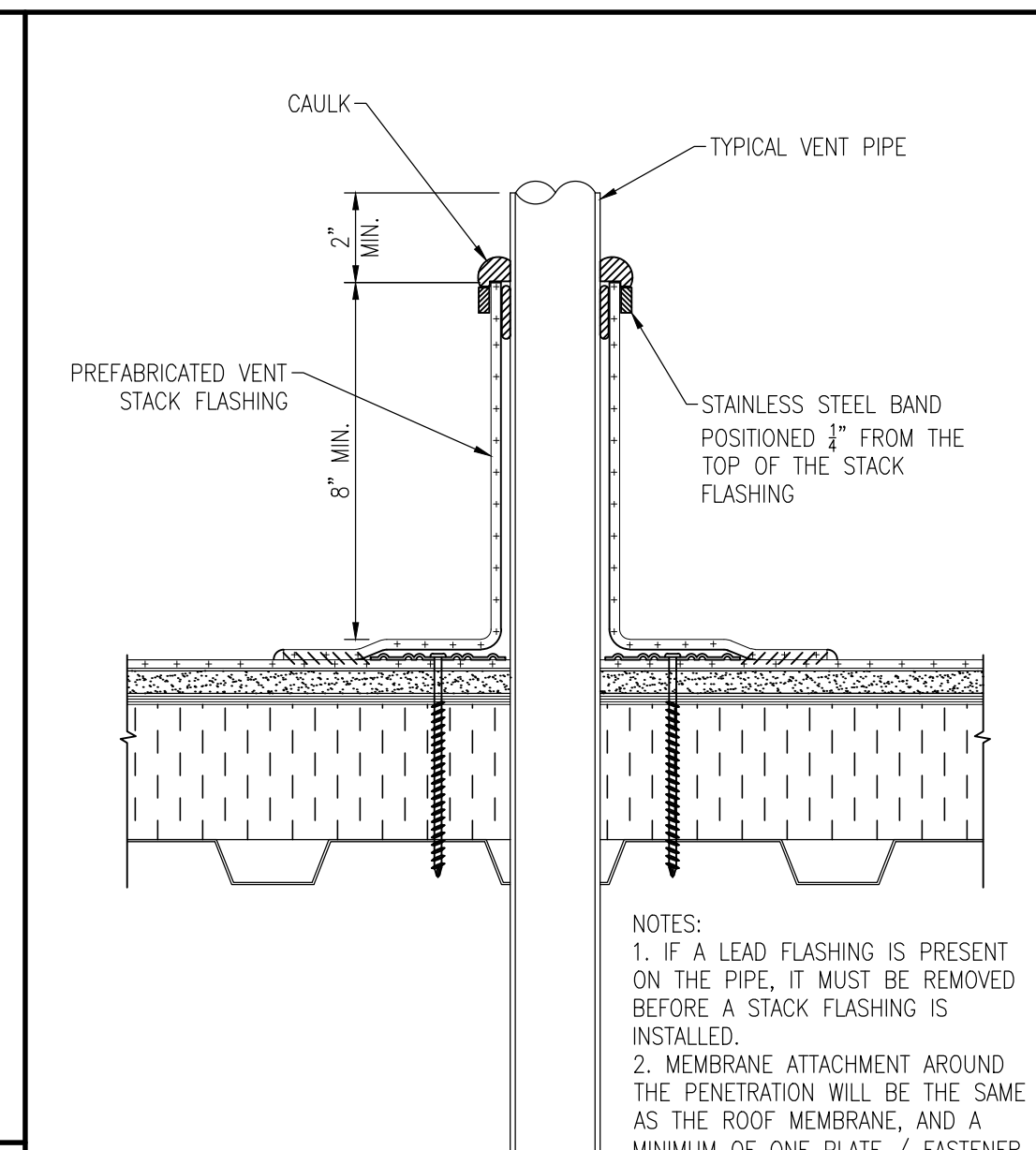

06 ROOF VENT PENETRATION
SCALE: 3" = 1'-0"

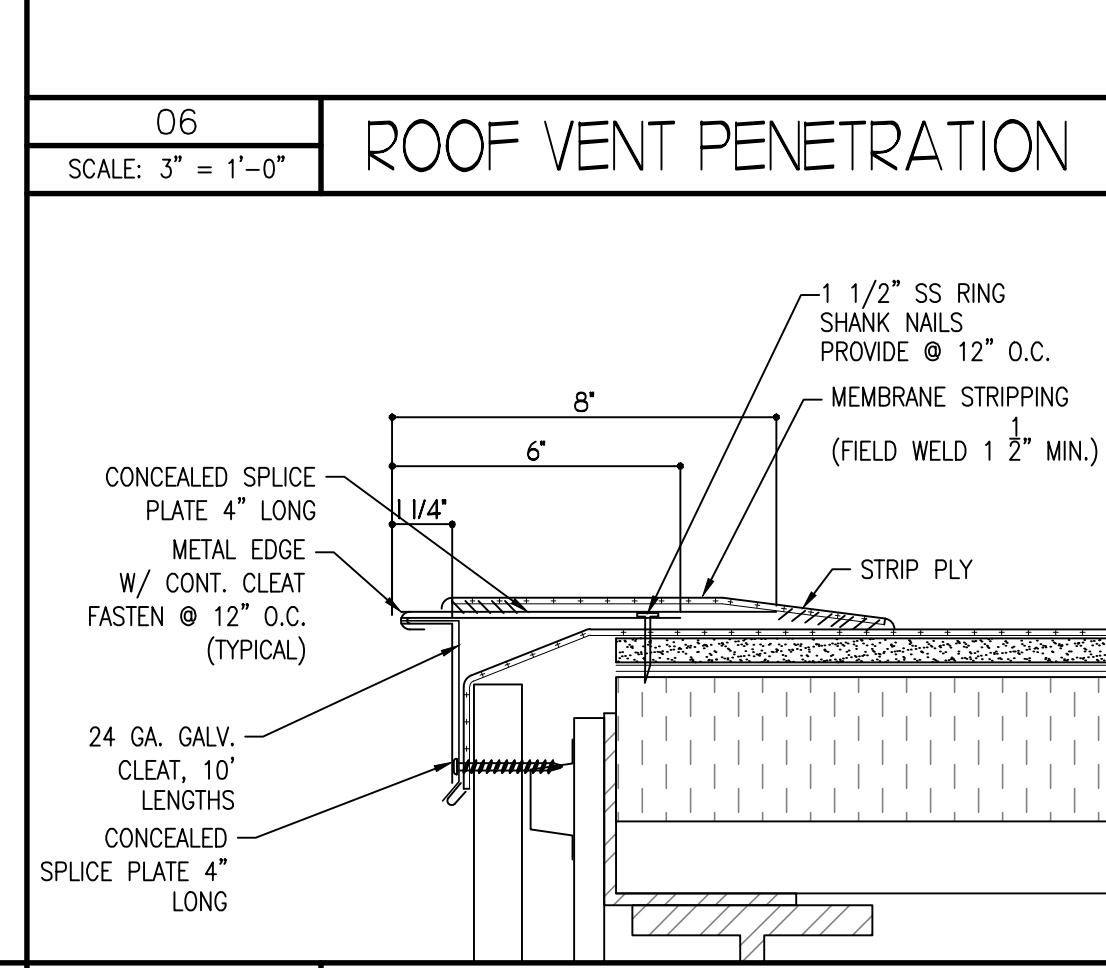

07 ROOF EDGE
SCALE: 3" = 1'-0"

GENERAL

- DRAWINGS ARE DIAGRAMMATIC AND MAY NOT SHOW ALL EQUIPMENT, MATERIALS, PENETRATIONS OR LOCATIONS. EXACT QUANTITIES AND LOCATIONS ARE TO BE VERIFIED BY THE ROOFING CONTRACTOR PRIOR TO BID BY VISITING SITE.
- CONTRACTOR IS RESPONSIBLE TO COORDINATE WITH SCHOOL PRINCIPAL ALL ACTIVITIES AND WORK PLANNED.
- CONTRACTOR IS TO ENFORCE ALL SAFETY MEASURES AND OSHA REGULATIONS.
- NO ITEMS SHALL BE STORED ON THE ROOF. TRANSPORT, HANDLE, STORE, AND PROTECT MATERIALS IN ACCORDANCE WITH MANUFACTURER'S INSTRUCTIONS. CONSTRUCTION EQUIPMENT SHALL BE STORED AND PLACED SO AS NOT TO ENDANGER PUBLIC, STAFF, STUDENTS OR WORKERS FOR THE DURATION OF THE CONSTRUCTION PROJECT.
- DO NOT REMOVE ANY MORE ROOFING THAN CAN BE REPLACED IN ONE DAY'S TIME. NO TEMPORARY ROOF OR PHASED CONSTRUCTION ALLOWED.
- DO NOT USE FLAME-PRODUCING EQUIPMENT FOR DEMOLITION.
- IT IS RECOMMENDED THE CONTRACTOR PHOTO DOCUMENT EXISTING GROUND AND ROOF CONDITIONS PRIOR TO WORK COMMENCEMENT.
- PROVIDE CRICKETS (SLOPE 1/2" / FT. MIN) ON THE UPSIDE SLOPE OF ALL ROOF TOP CURBED EQUIPMENT.

SITE

- AREA OF ACTIVITY SHOULD BE LIMITED TO SITE ACCESS AND STAGING / TEAR-OFF AREA. STAGING AND STOCK PILE AREAS WILL BE AGREED UPON AT THE PRE-CONSTRUCTION MEETING. ANY WORK TO BE PERFORMED OUTSIDE OF STATED AREAS SHOULD BE APPROVED BY OWNER OR ARCHITECT PRIOR TO PROCEEDING.
- CONSTRUCTION FENCING IS TO BE IN PLACE BEFORE ANY WORK IS TO COMMENCE. FENCING TYPE IS TO BE 4'-0" HIGH, ORANGE SAFETY, MAINTAIN AT ALL TIMES. ROOFING CONTRACTOR SHALL BARRICADE OFF ENTRANCES WHERE WORKING TO CONTROL ACCESS DURING CONSTRUCTION. DEMOLITION SHALL NOT COMMENCE UNTIL THESE ARE IN PLACE. SIGNS SHALL BE PROVIDED TO DIRECT PEDESTRIAN TRAFFIC.
- DEMOLITION DEBRIS MUST BE TRANSPORTED FROM THE SITE AT REASONABLE INTERVALS IN A MANNER WHICH PREVENTS INJURY OR DAMAGE TO PERSONS. STORAGE OF REMOVED ITEMS ON THE SITE WILL NOT BE PERMITTED, UNLESS MAINTAINED IN A DUMPSTER. DUMPSTER LOCATIONS ARE TO BE COORDINATED WITH OWNER AT PRE-CONSTRUCTION MEETING.

NOTE: ALL ROOF PENETRATION LOCATIONS AND QUANTITIES ARE APPROXIMATE AND ARE TO BE FIELD VERIFIED BY CONTRACTOR.

NOTE: ALL SQUARE FOOTAGE AND DIMENSIONS ARE APPROXIMATE AND ARE TO BE FIELD VERIFIED BY CONTRACTOR.

08 ROOF EDGE / CANT
SCALE: 3" = 1'-0"

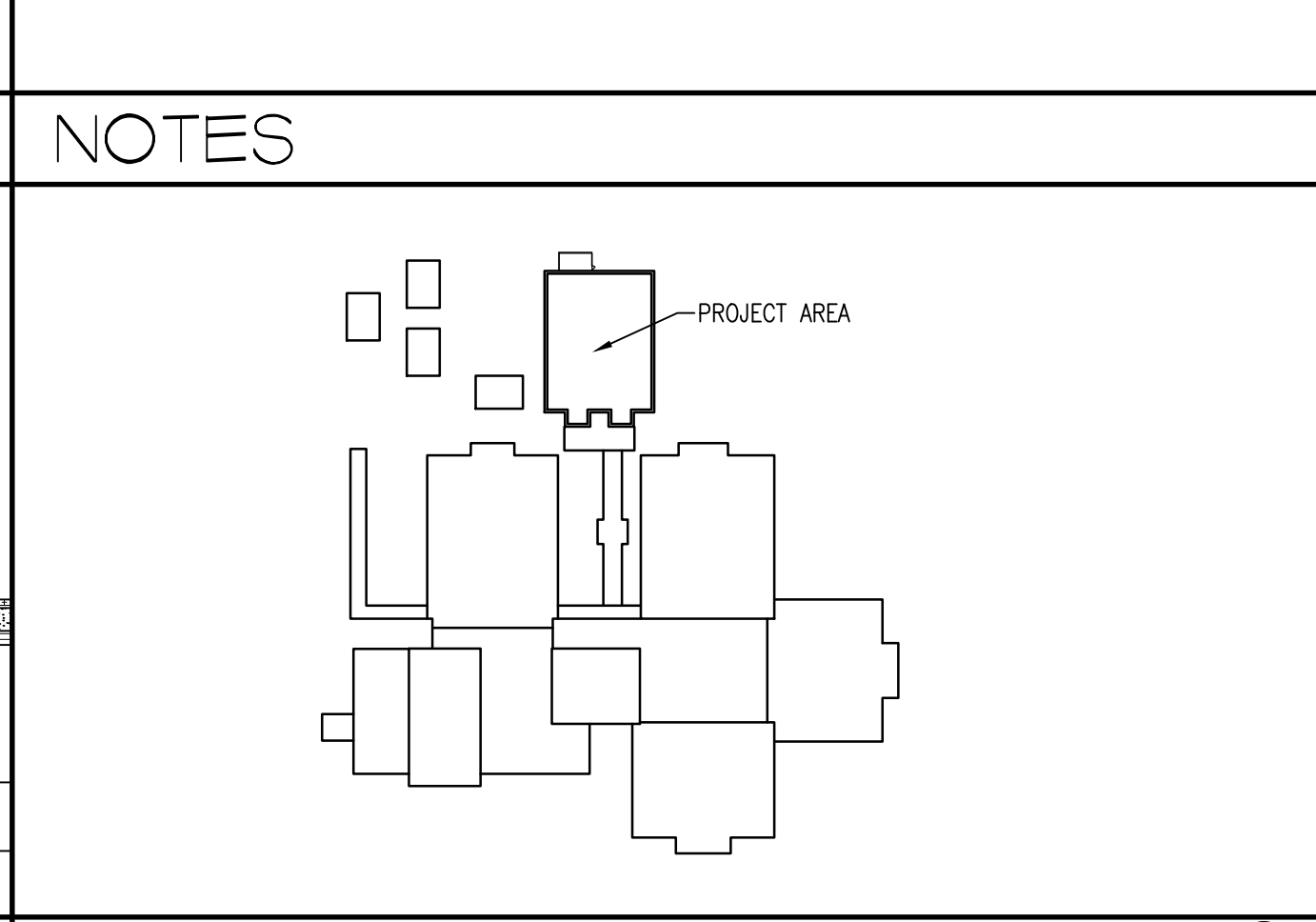

08 ROOF EDGE / CANT
SCALE: 3" = 1'-0"

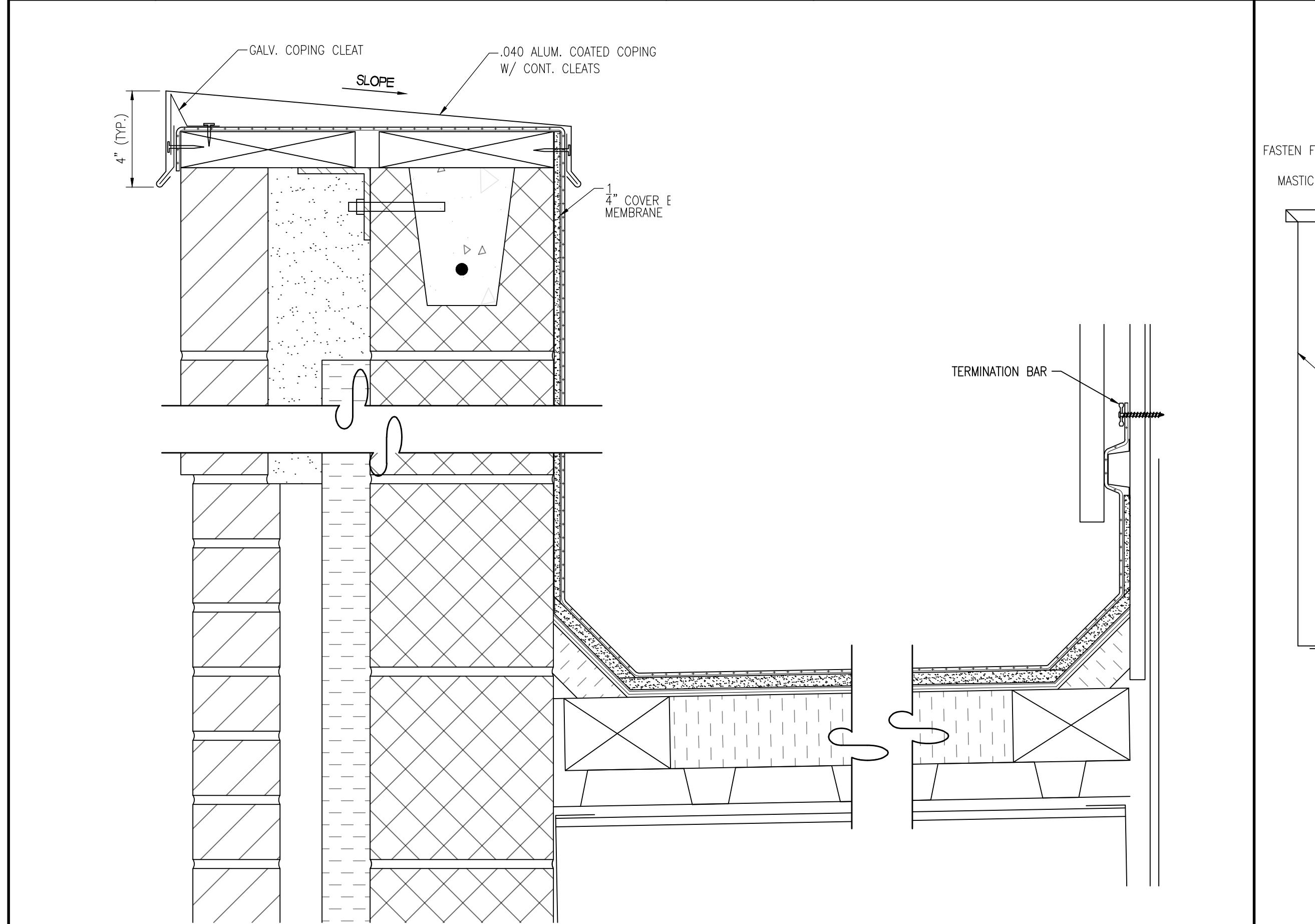

09 SCUPPER / COLLECTION BOX
SCALE: 3" = 1'-0"

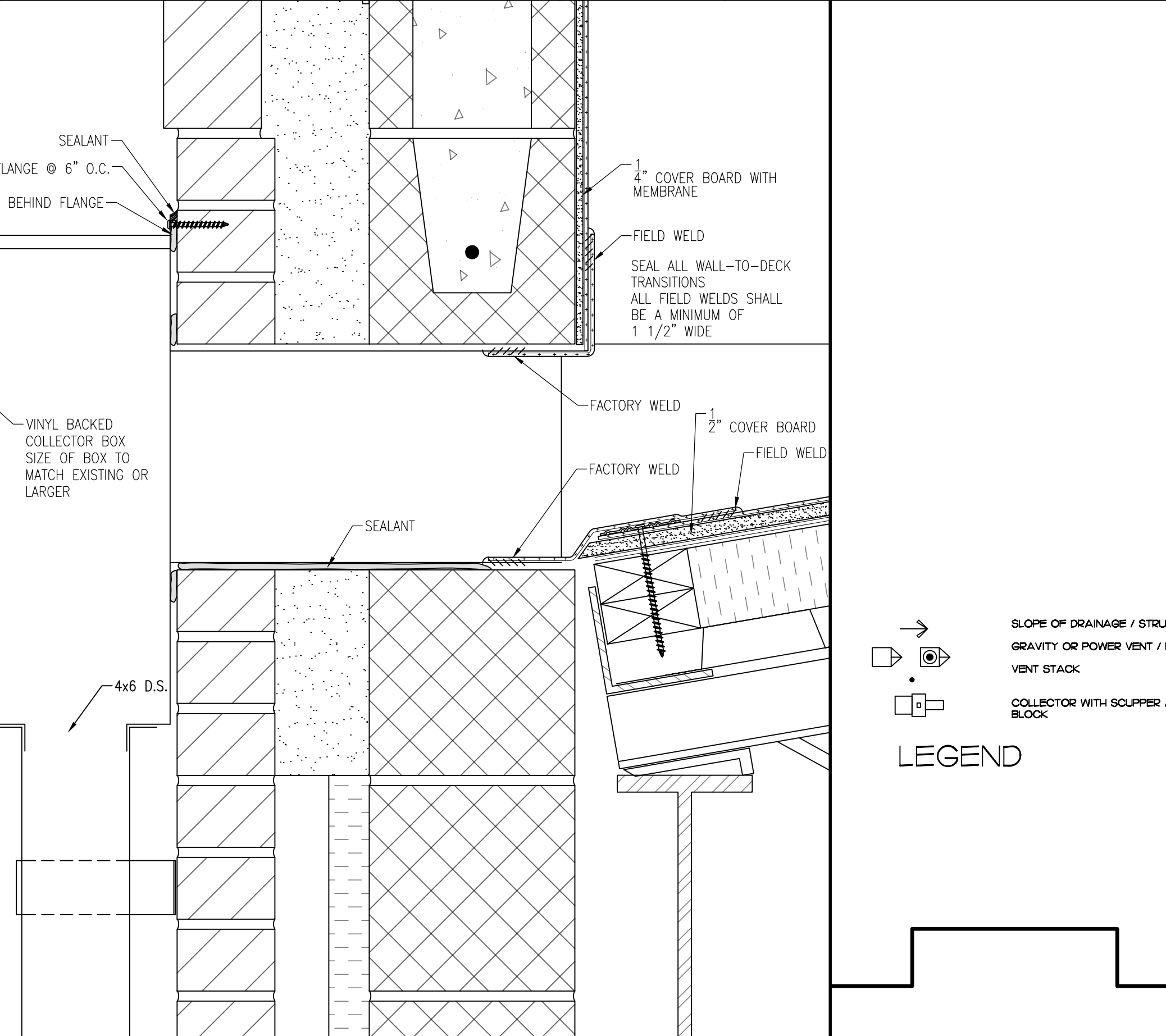

01 ROOF PLAN
SCALE: 1/16" = 1'-0"

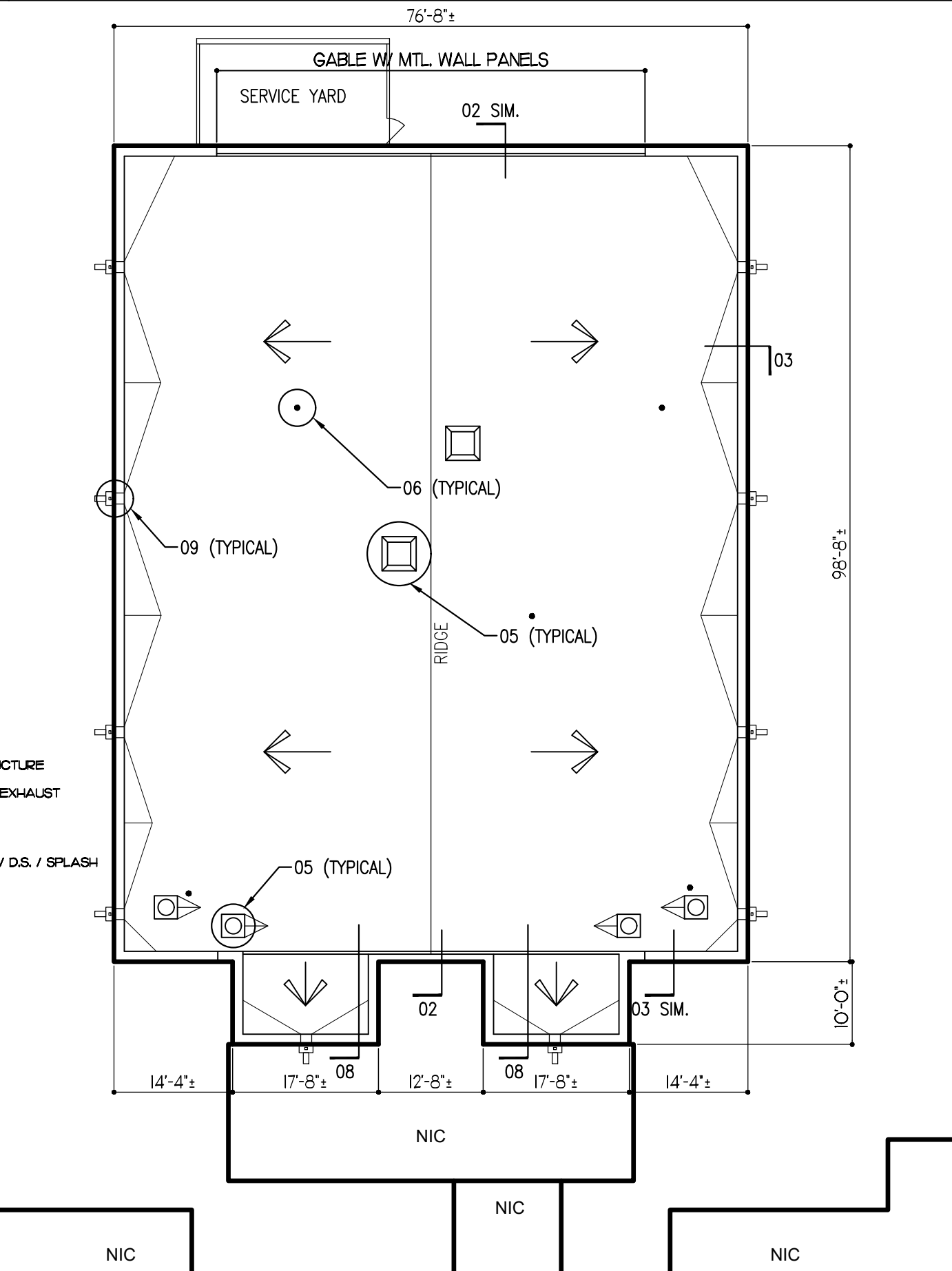

KEY PLAN
REF. NORTH

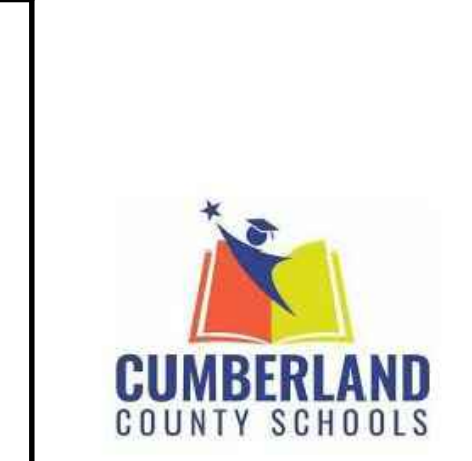
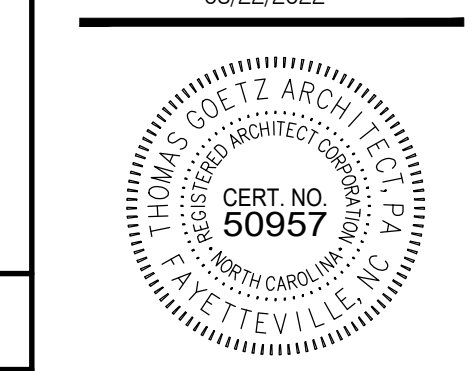
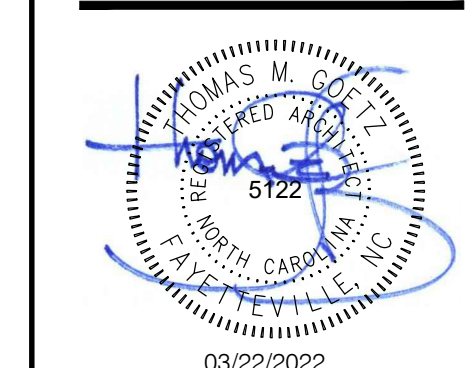

MONTCLAIR ELEMENTARY SCHOOL

555 GLENSFORD DRIVE
FAYETTEVILLE, NORTH CAROLINA
28314

RE-ROOFING

SHEET TITLE
ROOF PLAN, NOTES, & DETAILS

DRAWINGS, SPECIFICATIONS AND DESIGN ARE AND SHALL REMAIN THE PROPERTY OF THE ARCHITECT. WHETHER THE PROJECT FOR WHICH THEY ARE PREPARED IS EXECUTED OR NOT, THE ARCHITECT RETAINS ALL RESERVED RIGHTS, INCLUDING COPYRIGHTS THERE TO. THE DRAWINGS AND SPECIFICATIONS SHALL NOT BE USED OR MODIFIED BY THE PROJECT OWNER OR ANY OTHER PARTY FOR OTHER PROJECTS. ADDITIONS TO THIS PROJECT, OR FOR COMPLETION OF THIS PROJECT EXCEPT BY AGREEMENT IN WRITING AND WITH APPROPRIATE COMPENSATION TO THE ARCHITECT. DRAWINGS MAY NOT BE REPRODUCED OR DIGITALLY STORED WITHOUT WRITTEN CONSENT OF THE ARCHITECT.

ADA AND LEGAL DISCLAIMER
THIS DOCUMENT IS NOT REPRESENTED TO COMPLY WITH ALL REQUIREMENTS CONTAINED IN THE AMERICANS WITH DISABILITIES ACT (ADA) OR OTHER LAWS. ARCHITECTS AND ENGINEERS ARE NOT LICENSED TO INTERPRET LAWS OR GIVE ADVICE CONCERNING LAWS. THE OWNER SHOULD HAVE THIS DOCUMENT REVIEWED BY HIS ATTORNEY TO DETERMINE IF IT COMPLIES WITH ADA AND OTHER LAWS.

JOB CODE: 22CCSS141
DRAWN BY: ROG
CHECKED BY: TMG
REVISION:
SHEET NO.:

A100

DATE: MARCH 22, 2022